

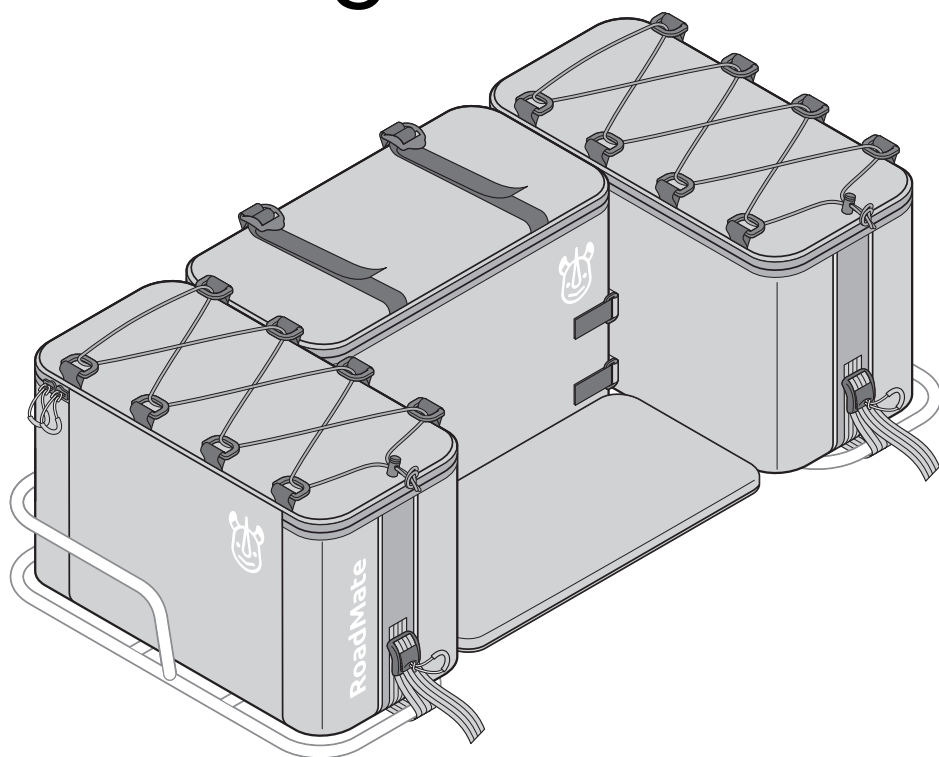

ATV Bag



USER MANUAL

Thank you for choosing the Rhino RoadMate ATV Bag!

You're now ready for rough rides with everything you need neatly secured at the back of your quad.

We're here to help!

At Rhino, we stand behind our products. Our team will be happy to help you out with instructions, product care, and any other issue that you might face.

If you need assistance or advice, please email us at **hello@myrhinoproducts.com**



Our top priority is your satisfaction and confidence in products we manufacture

IMPORTANT:

- Please read this manual before assembling and using the bag, and keep the manual for reference.
- Don't use the product in any ways that are not described in this manual.



How to Assemble the Rhino RoadMate ATV Bag

You will need:

a 3 folded bags

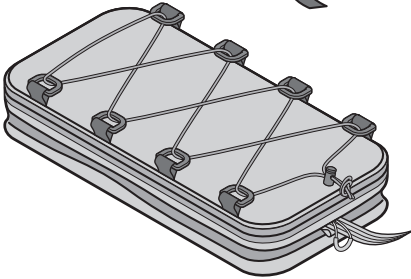
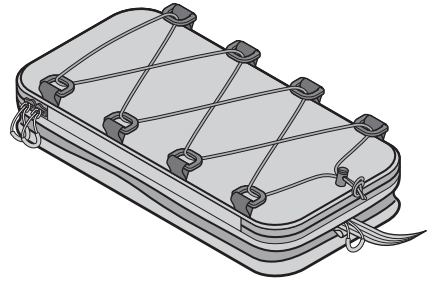
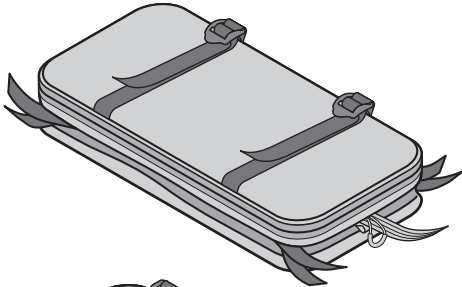

b 1 detachable seat

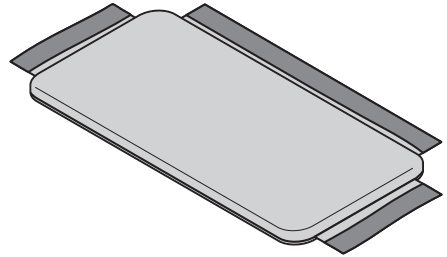

d 12 short rods
(9 inches long each)



e 12 medium rods
(10.2 inches long each)



f 12 long rods
(18 inches long each)



c 24 corner connectors



Build the first frame by inserting rods into corner connectors. You will end up with a frame that fits the shape and size of each box, like this:

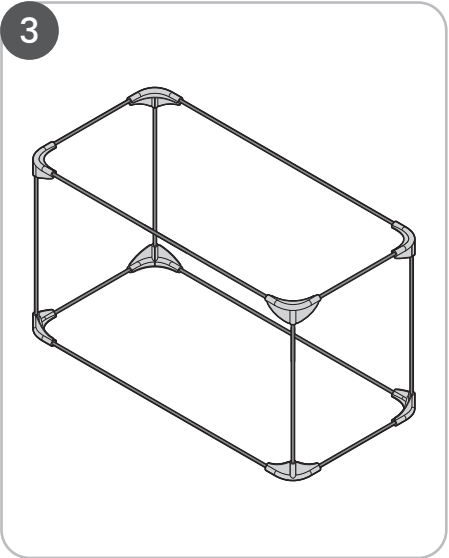
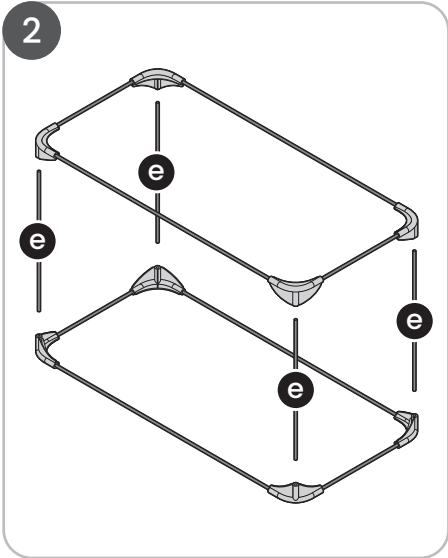
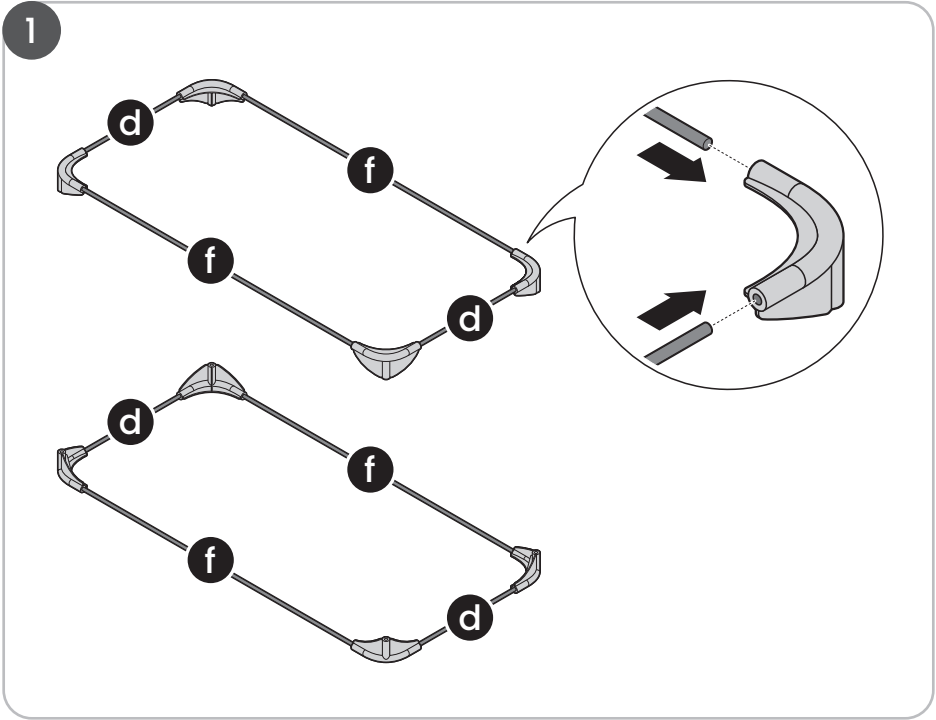

Insert the frame into one of the bags (the three bags are identical in size, and the three frames are identical in size, too). Start with the middle bag (it has straps on top, whereas side bags have elastic cords on top).

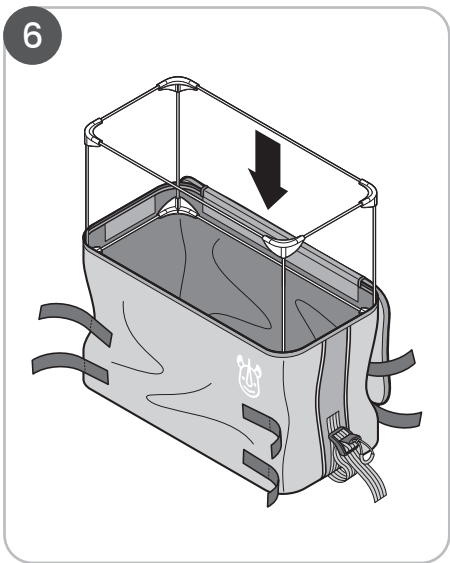
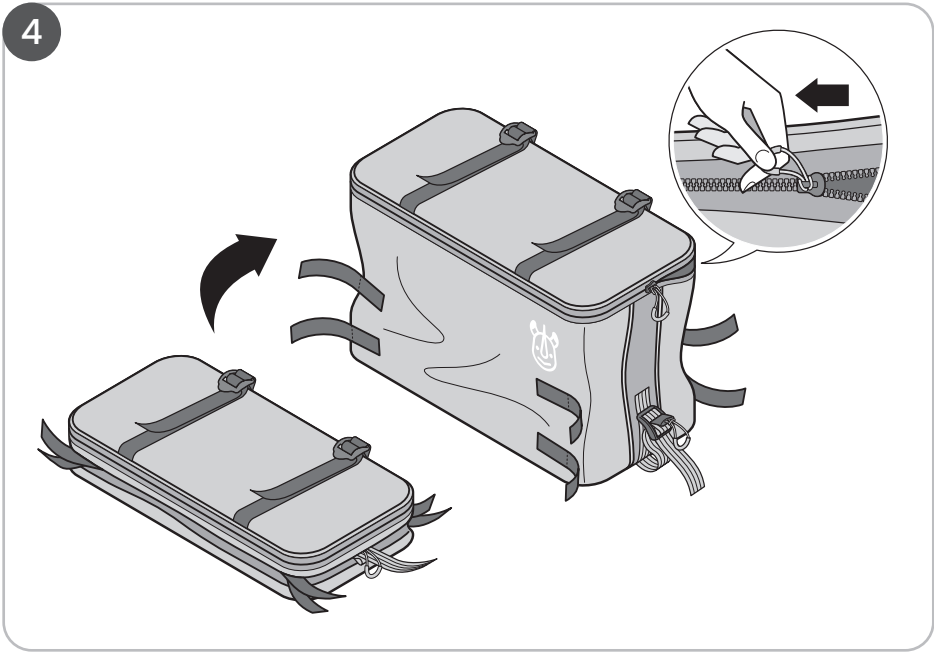

NOTE:

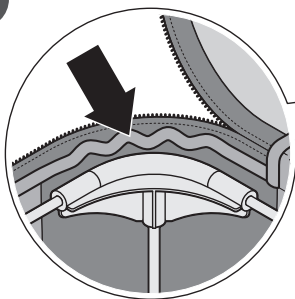

The top rods of the frame should go beneath special hard hems that are in the upper part of each bag, just below the zipper.

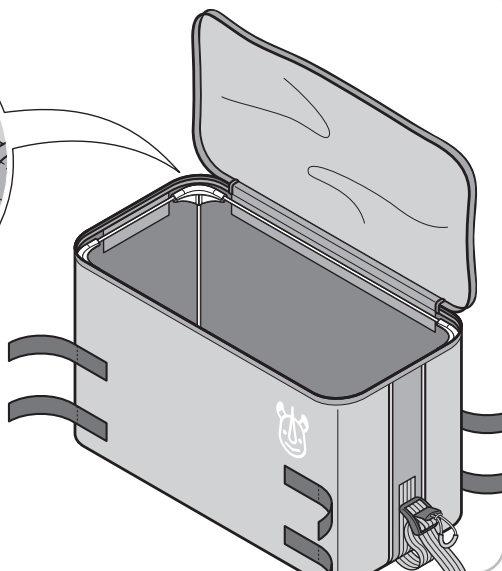

Secure the frame with four hook-and-loop flaps that go over the rods. Close the bag with the zipper.

7

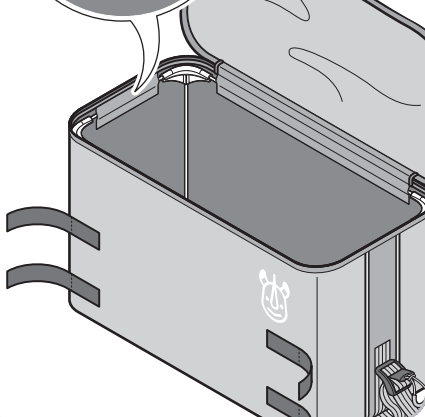
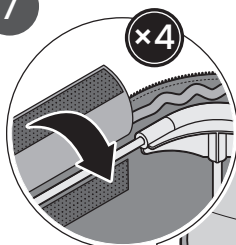

8

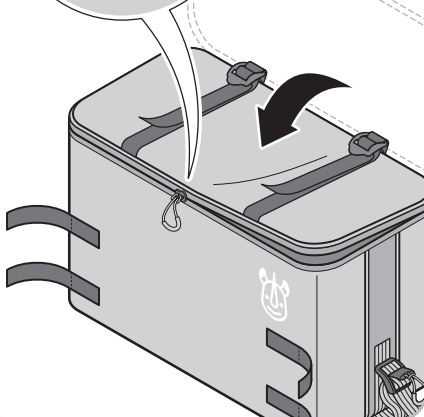
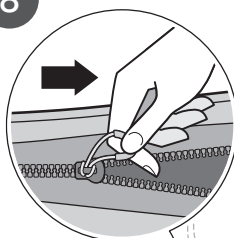

Repeat steps 1 through 8 for the two remaining frames and two remaining bags (the ones with elastic cords on them). At the end of this step you will have 3 fully assembled bags.

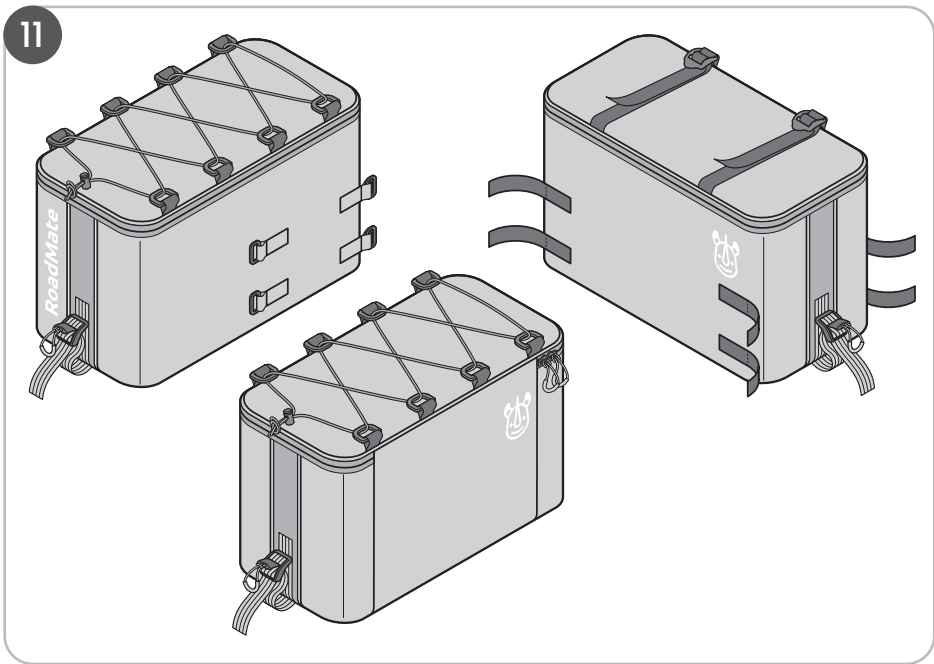
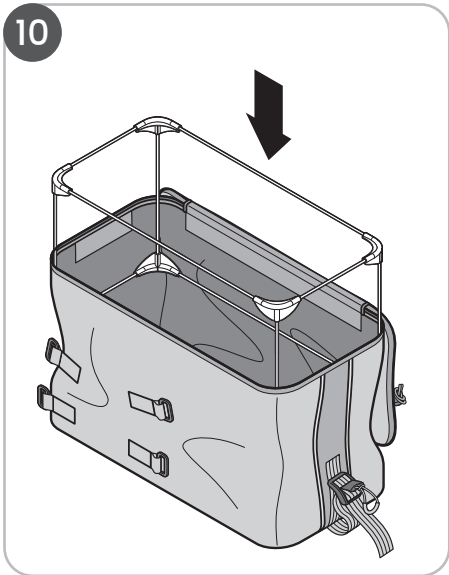
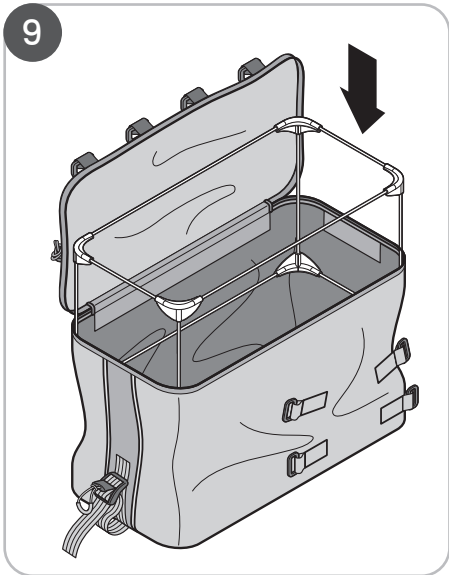

Attach the middle bag to your ATV using rubberized straps (the ones with gray stripes on them) at the bottom part of the bag. Use the pullers on the straps to make sure that the bag are fixed tightly. Repeat for the side bags (they have the same rubberized straps, too).

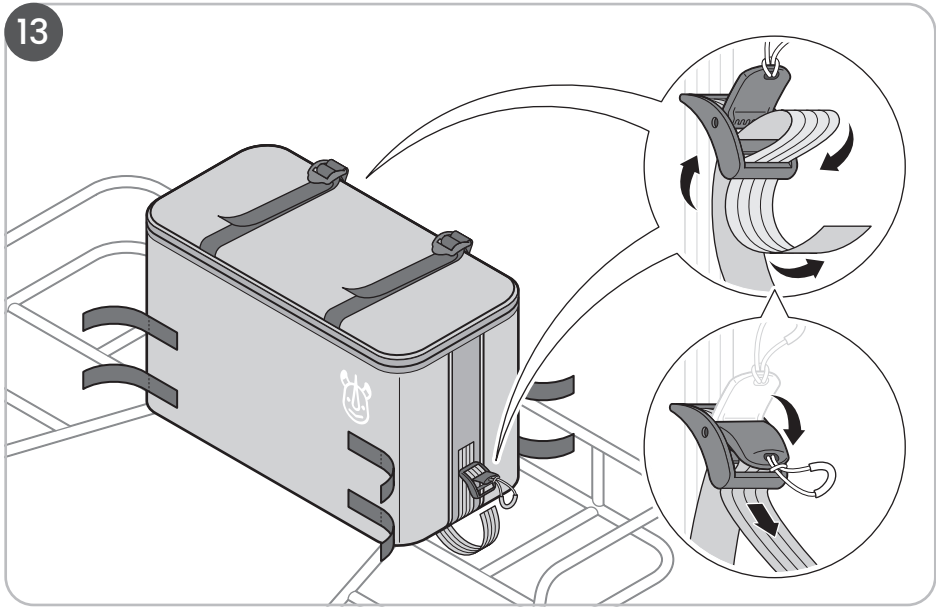
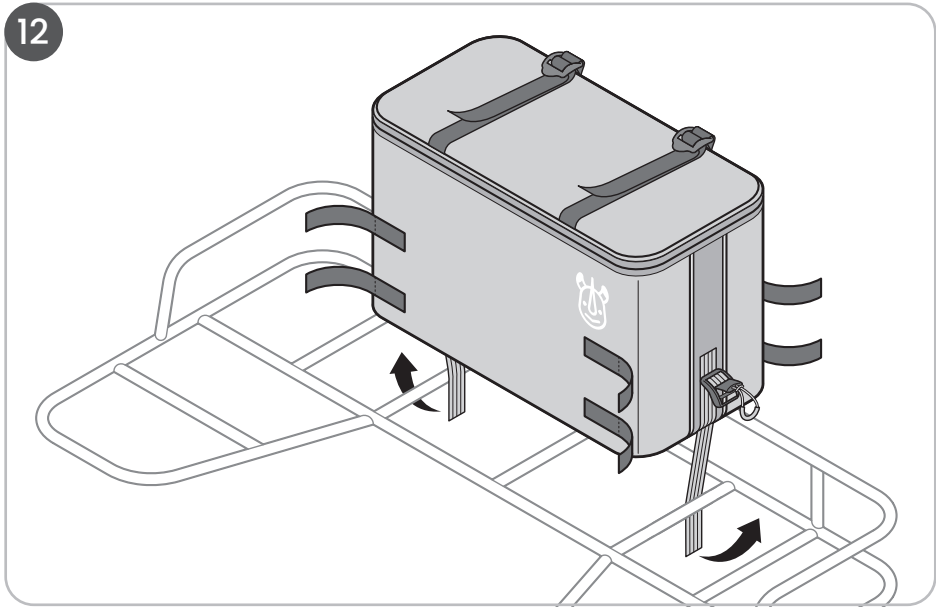

Connect the bags to one another using straps that have hook-and-loop fasteners on them. When the bags are connected, the lids of the side ones should be opening outwards (away from the middle bag), and the reflective logos should be facing outwards, too.

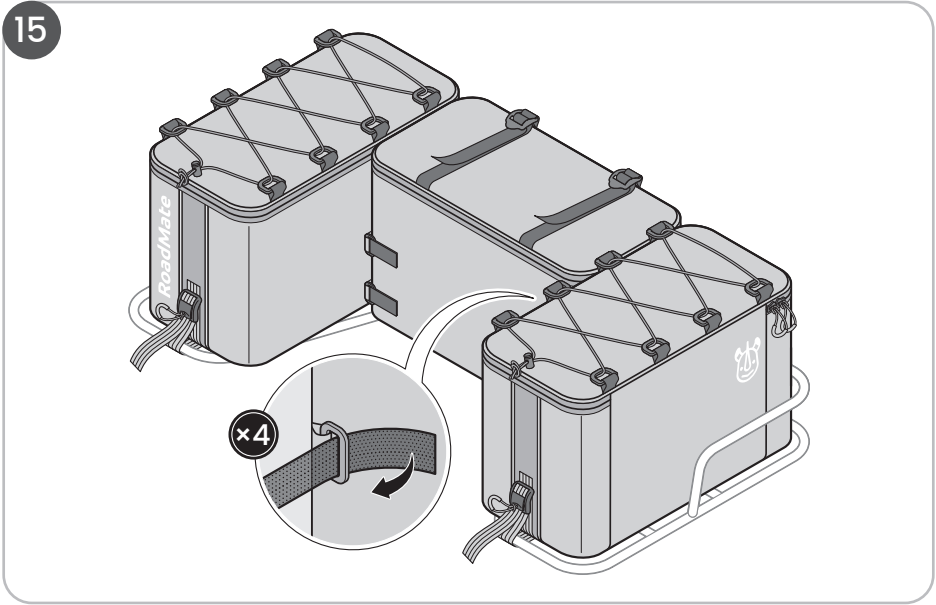
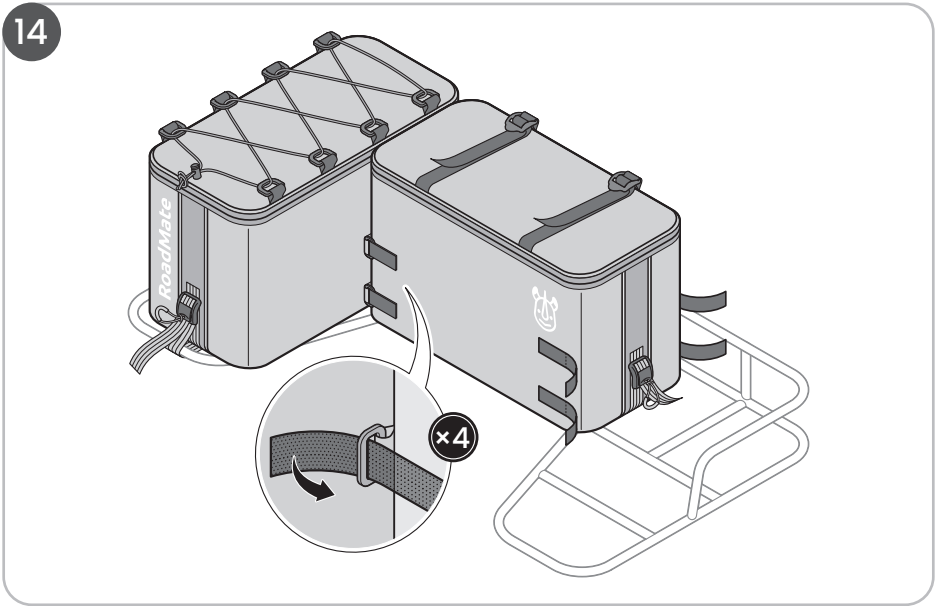

Optionally, attach the seat using hook-and-loop fasteners on the bottom.

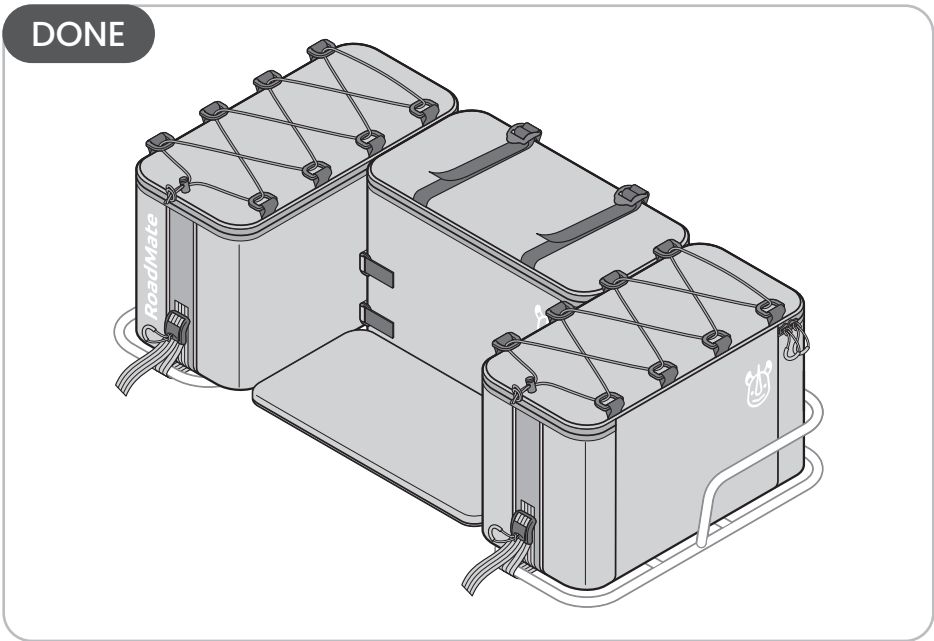
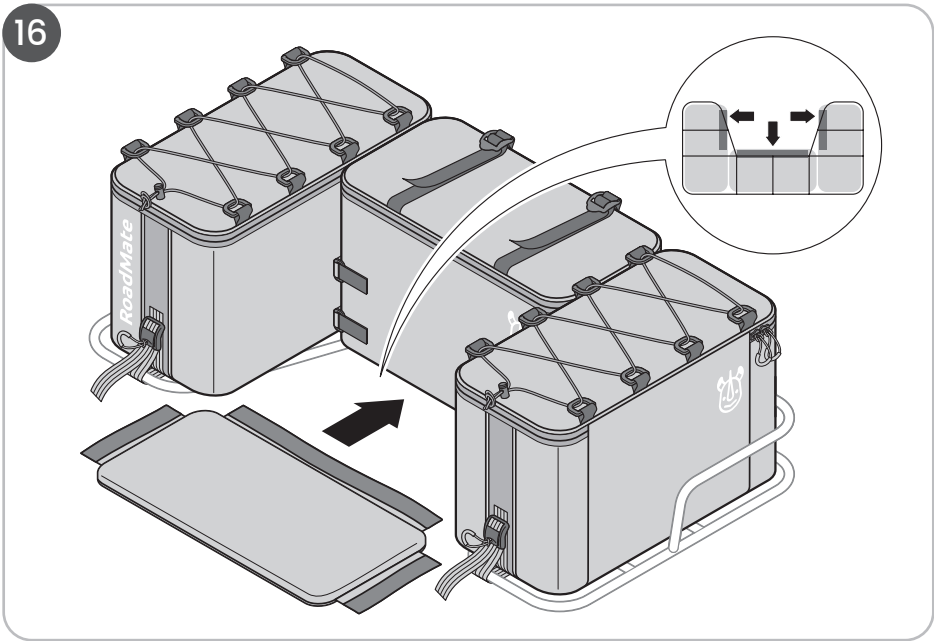

Enjoy your new, reliable storage space!

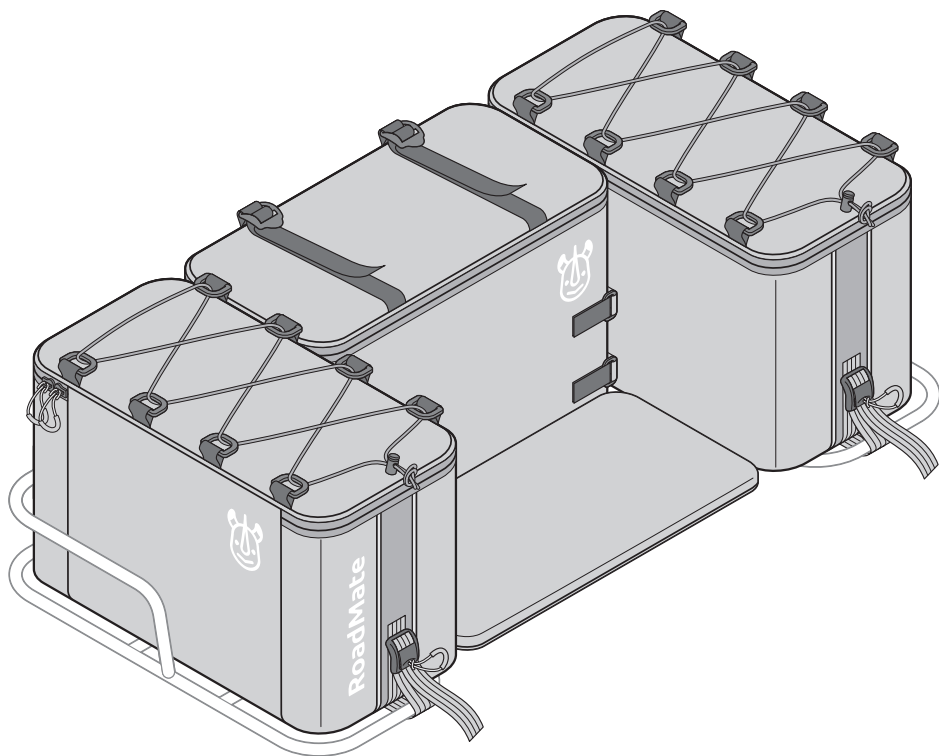

We are confident that you have made the right decision in choosing our durable and spacious bag for your outdoor adventures.

Featuring three large compartments and straps to securely hold your gear, this bag has plenty of room for all your gear, from extra clothing and snacks to tools and emergency supplies. Plus, its weather-resistant construction ensures your belongings stay dry and protected no matter what Mother Nature throws your way.

We hope that you enjoy using our rear bag for ATV racks and that it enhances your outdoor experiences!

WARRANTY INFORMATION

Validate Your Warranty Now!

To claim your warranty please register now at

<https://www.rhinoroadmate.com/warranty>



Once registered, you can rest at ease knowing that if anything goes wrong with your product, you are covered!

We stand behind our products!

2-Year Warranty on any defect in this product

If within two years from the date of purchase this product fails due to a defect in material or workmanship, Rhino will repair or replace the product or necessary components free of charge.

This warranty excludes:

- Damage caused by accident, abuse, mishandling, or transport.
- Units subjected to unauthorized repair.
- Units not used in accordance with user instructions.
- Damage exceeding the cost of the product.
- Deterioration of the delivered product resulting from abnormal storage and/or safeguarding conditions on the client's premises.
- Failure to provide the dated proof of purchase.